

MODEL 810-TW INCLUDES

PART ID	DESCRIPTION
0132	STAINLESS STEEL (SS) CABINET, SS HEAD, DELIVERY CHUTE, LOCK AND KEYS, AND M810 BOOK TRUCK FEATURES GENTLE DROP NO-TIP FLOOR

ACCESSORY OPTIONS

PART ID	DESCRIPTION
0608	LOCKABLE LIFT PLATE INCLUDES LOCK BAR, PAD LOCK, AND 2 KEYS
1806	EXTRA M810 BOOK TRUCK FEATURES GENTLE DROP NO-TIP FLOOR
1114	COLOR COATED ARMOR ENTIRE STAINLESS STEEL HEAD ONE COLOR

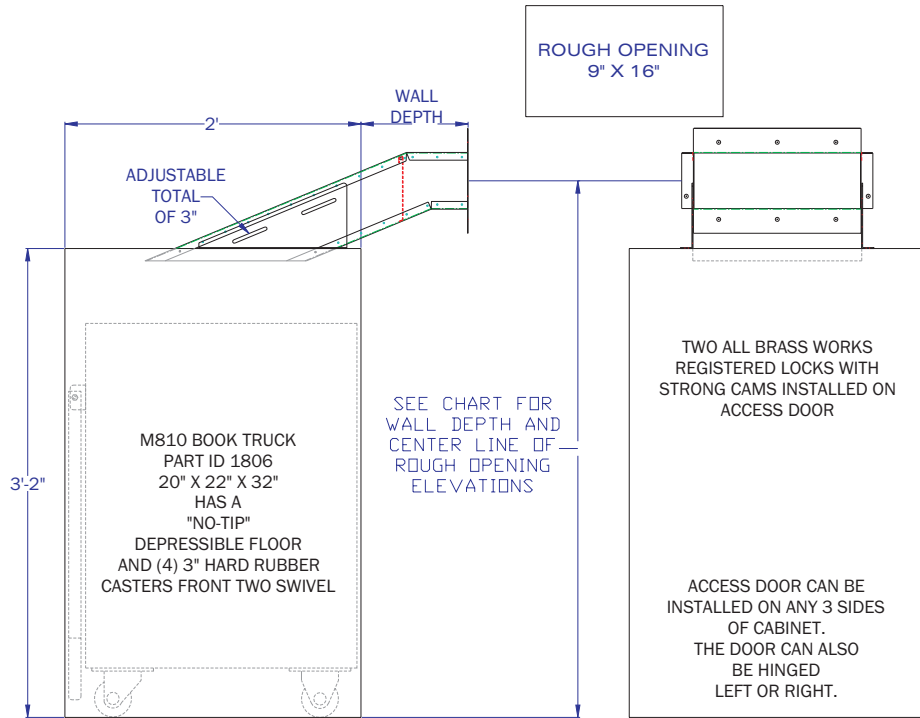

LEFT SIDE VIEW

FRONT VIEW

SS HEAD & DELIVERY CHUTE DETAIL

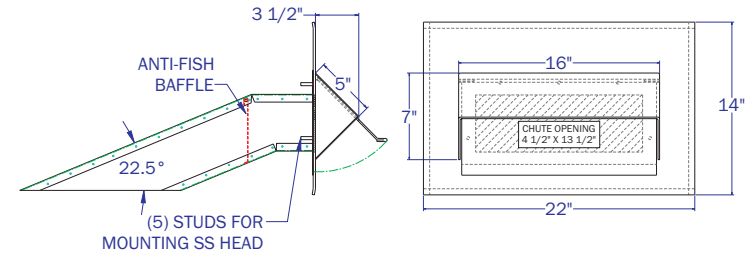

M810-TW ANCHORS WITH (4) 1/2" SS ANCHORS

1. MARK AND DRILL HOLE SAME SIZE AS ANCHOR
2. TAP IN ANCHOR
3. SECURE WITH WRENCH

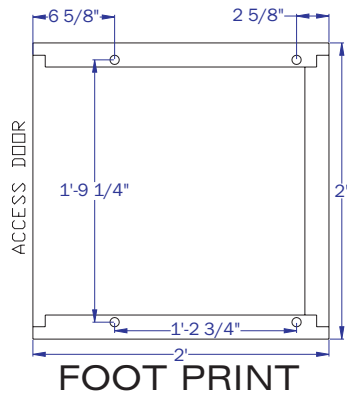
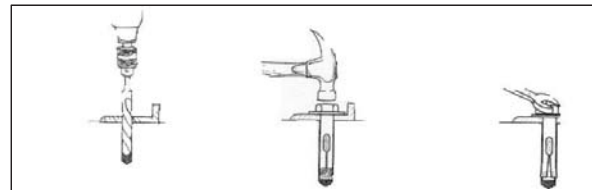

FOOT PRINT

WALL DEPTH ELEVATIONS

ASSUMES SAME INTERIOR AND EXTERIOR GRADE

WALL DEPTH	C.L OF ROUGH OPENING
4" - 6"	41 1/2" - 42 1/4"
6" - 8"	42 1/4" - 43"
8" - 10"	43" - 44"
10" - 12"	44" - 44 3/4"
12" - 14"	44 3/4" - 45 1/2"
14" - 16"	45 1/2" - 46 1/2"
16" - 18"	46 1/2" - 47 1/4"
18" - 20"	47 1/4" - 48"

THE INFORMATION CONTAINED IN THIS DRAWING IS THE SOLE PROPERTY OF AMERICAN BOOK RETURNS. ANY MISUSE IN PART OR AS A WHOLE IS STRICTLY PROHIBITED BY AMERICAN BOOK RETURNS.

AMERICAN BOOK RETURNS
120 6TH AVE. NORTH
ST. CLOUD, MN 56303
320-253-3044

TITLE

M810 THRU-WALL_CUT SHEET

PART NAME

MODEL 810-TW

REV	DESCRIPTION	DATE	BY	TOL: UNLESS OTHERWISE SPECIFIED ANGLES: ±1° .XX±.030 .XXX±.010
	RELEASE	04-23-09	JRS	

SHEET

1 OF 2

PART ID #

0132

SCALE

NTS

REV